

## Note:

- 1.The installation instructions may differ slightly from the actual operation. If there are any differences,please follow the actual situation or contact us.
- 2.Warning: Please do not disassemble any part by yourself,any improper operation will not be covered by our warranty.



**Installation Tutorial**

Note: if the temperature is too cold, please heat adhesive tape with the hairdryer before pasting



## Front Row Installation Steps



1.Clean the installation position



2.Tear off the adhesive tape



3.Apply adhesive aid



4.Align the installation position and press the door to stick it



3.Put the large black rubber gasket to the small black rubber gasket(**Note:The surface is upward**)

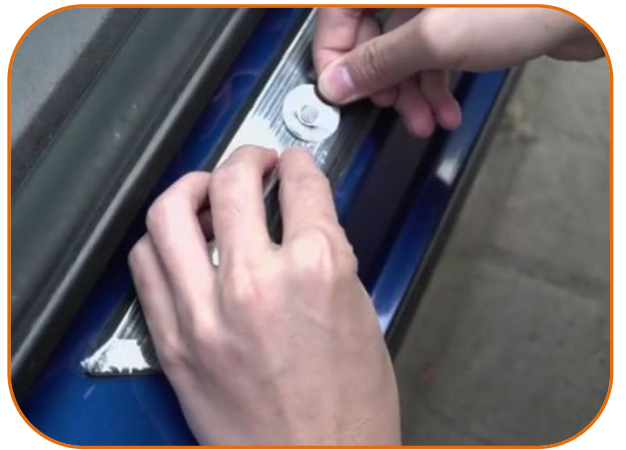

4. Tear off the film of the magnet and put the magnet on the rubber ring (**the adhesive surface is upward**)



5.Close the door and the large black rubber with magnet will stick to the door



6.magnet stick on the door



7.Tear off the plastic film



8.Finish installation

Rear Door Sill Installation Steps



1.Align the installation position



2.Put the positioning sticker on the corresponding position

The subsequent installation steps is the same as before



battery position for front door sill

Note: If the front door sill does not light up after the battery is added, try to reverse the positive and negative poles of the left and right batteries