

KIT

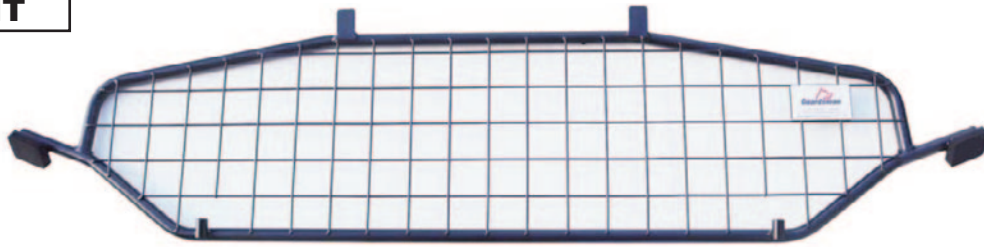

A



B x2
@445mm



C x2

**READ FULLY BEFORE BEGINNING - IT'LL MAKE MORE SENSE!
VOR DEM ANFANG VOLLSTÄNDIG LESEN - ES WIRD MEHR SINN MACHEN!**

Drop seats.
Insert Guard.
Mesh to Back of
the Car.

*Klappsitze.
Hundegitter
einsetzen.
Netz an der Rück-
seite des Autos*

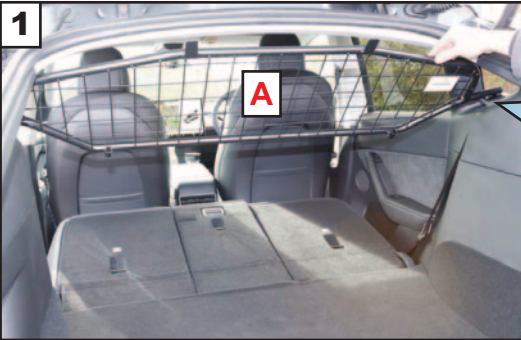

1

A

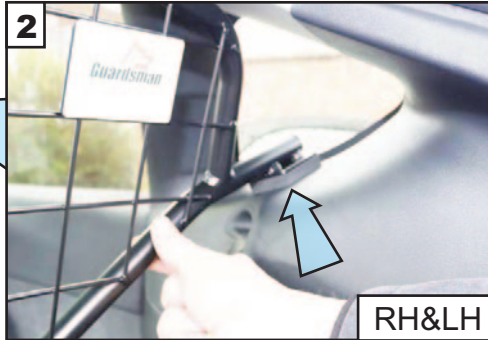

2

RH&LH

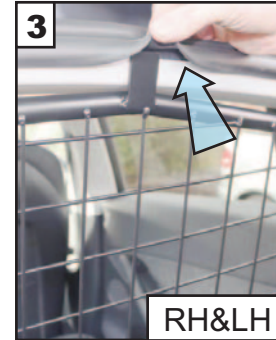

3

RH&LH

Lock seat backs
in the **fully
reclined** position.

*Verriegeln Sie die
Sitzlehnen in der
vollständig
zurückgelehnten
Position.*

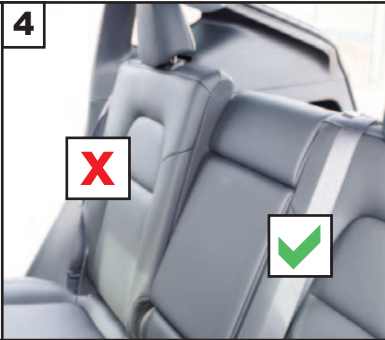

4

X

✓

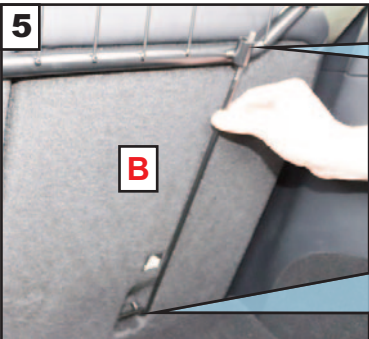

5

B

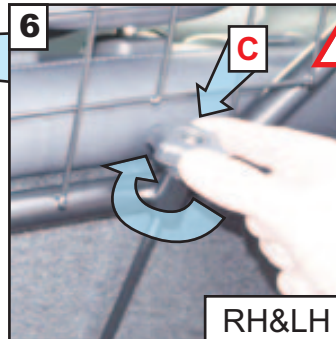
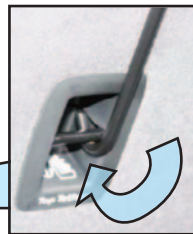

6

C

RH&LH

Tighten as this
So festziehen

✓

Not this
Nicht das

X

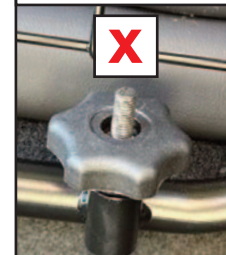

✓

**Tesla Model Y
DOG GUARD
Part No. G1622
FITTING INSTRUCTION**

**HUNDEGITTER
EINBAUANLEITUNG**

**PROTECTION CONTRE LES CHIENS
INSTRUCTIONS DE MONTAGE**

**HUNDEGITTER
MONTERINGSVEJLEDNING**

**CONJUNTO PROTECTOR
PARA PERROS
INSTRUCCIONES DE MONTAJE**

**KIT BARRIERA CANI
ISTRUZIONI DI MONTAGGIO**

**HUNDEVERNGITTER
MONTASJEVEILEDNING**

**HONDENBESCHERMINGSREK
INBOUWINSTRUKTIES**

**SATS HUNDSKYDD
MONTERINGSANVISNING**

**KOIRAN TURVARISTIKKO
ASENNUSOHJEET**