

Note:

- 1.The installation instructions may differ slightly from the actual operation. If there are any differences,please follow the actual situation or contact us.
- 2.Warning: Please do not disassemble any part by yourself,any improper operation will not be covered by our warranty.
- 3.Before installing the product, watch the installation video and manual carefully.
- 4. Before installing the product, please turn off the vehicle power and cut off the negative electrode of the frunk battery.

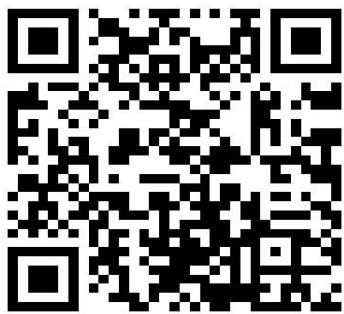

Installation video QR code



Product List



Installation Steps



1. Schematic diagram of harness routing position.



2. Turn off the host power on the screen.

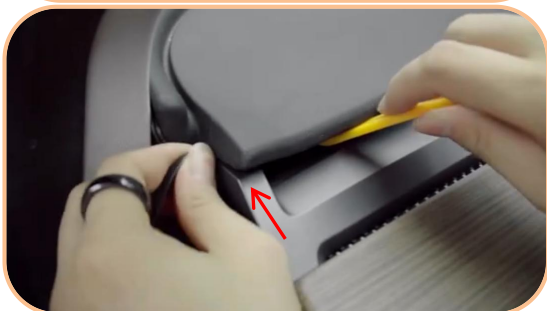

3. First, insert the small HUD ① into the air outlet of the air conditioner in the middle of the steering wheel, and then hide the harness.



4. Remove the trim panel cover with a pryboard; then route the harness according to the wiring diagram as shown on the picture



5. Pry off side trim panel cover on the center console

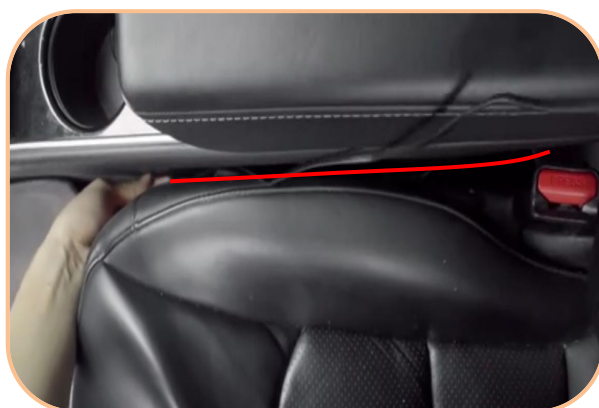

6. Route the harness to the back of the center console saddle



7. Connect the plug ②



8. Remove the trim panel cover on the back of center console

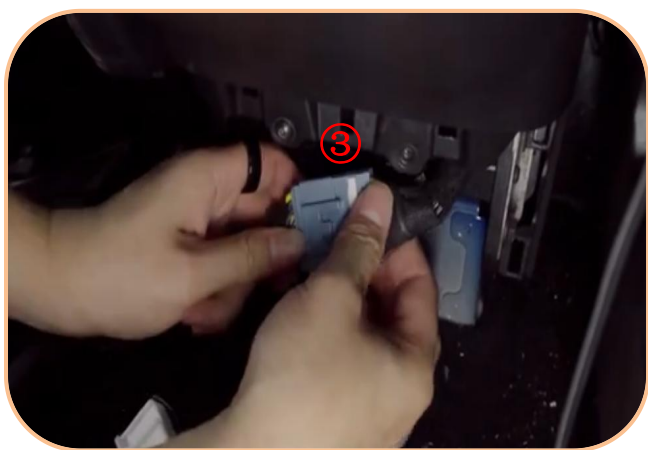

9. Connect **plug ③** with the blue plug of the original vehicle.